

## TABLE OF CONTENTS

## PAGE

Rules and Regulations	2
Floor Plans of the Stages	4
Rate Sheet	6
In-House Equipment	7
Equipment Packages	9
Around the Neighborhood	10

**Cyc Stage**  
305 Ten Eyck St.  
Brooklyn, NY 11206

**Stage Office**  
305 Ten Eyck St.  
Brooklyn, NY 11206

**Raw Stage**  
315 Ten Eyck St.  
Brooklyn, NY 11206

info@chemcreative.com  
(718) 386-4127

# RULES AND REGULATIONS

---

## HOLDS

A soft hold will be given to any production who requests it. In the event that more than one production is interested in the same date(s), those productions will be given a 2nd or 3rd soft hold. Productions with a 2nd or 3rd soft hold can challenge previous holds. **When a hold is challenged, those with the earlier holds are given 24-48 hours to pay their deposit and confirm their solid hold. If the previous holds decide to release their holds, the challenger can confirm a solid hold with a 50% deposit.**

## CONFIRMATIONS AND CANCELLATIONS

A 50% deposit is required to confirm a hold. A confirmed hold cannot be canceled.

## PAYMENT

All productions must pay a 50% deposit on both their stage and equipment invoices prior to arrival at Chemistry Creative. Remaining balances must be paid no later than the production's last day at our stages. Overtime charges, equipment additions, and expendables will be billed to you on future invoices, if applicable, and should be paid within fourteen days of receipt. Please inform us of your preferred method of payment. If paying with card a 3% surcharge is added to the total.

## CONTRACT

Our standard contract, which will be emailed to you must be signed and returned to us (via email or fax) at least two business days before your shoot. Please inform us who the signing producer will be on said contract. Please note our license agreement is made with the party insuring the production. Therefore, the license agreement will only list the party and address of the insured as well as the individual communicated to the company as the designated representative of the Insured.

## EQUIPMENT

Chemistry Creative does provide grip and lighting equipment. We'd love to be the provider of your equipment, but in the case that you'd prefer to supply your own gear, we will charge a lighting convenience fee of \$500.00 / day. Please see "In-House Equipment" on pages 6-7 to learn more about our in-house gear and very affordable equipment packages. If your shoot is looking for something we don't have in-house, we can easily sub-rent any items not currently available in-house. Keep in mind when submitting your equipment rental order to submit it at least three business days in advance of your first day at our stages to ensure its availability. Waiting longer to submit this order may result in your desired equipment being unavailable and your production could incur a Lighting Convenience Fee.

## PRODUCTION SUPPLIES, EXPENDABLES, AND ADDITIONAL RENTALS

Chemistry Creative is also happy to supply your production with a wide variety of supplies and expendables. We generally do expendables per-use, but please let us know at least three business days in advance of your stage rental what expendables you'll be needing so we can have them on hand. We're also happy to provide additional production rentals for you, but again please let us know at least three days in advance so we can have them available.

## **TAX STATUS**

If your production has tax-exempt status, please inform the Studio Manager working on your project and submit your Exempt Use Certificate via email or fax.

## **AMENITIES**

Included with all space rentals are four tables, fifteen chairs, four racks, one steamer, one mirror, speakers, and in-house WiFi. Extra amenities can be made available as an additional rental.

## **CALL TIMES**

Please inform us of your estimated in and out times for each day of your production at least two days in advance of your first day at our stages to ensure proper scheduling. If these call times change, it is your responsibility to inform the Studio Manager and/or Stage Hand working on your project. When scheduling your shoot, please keep in mind that daily start times can be as early as 7:00am. If a start time is later than 10:00am and the shoot is scheduled to end after 9:00pm there will be a Late Opening charge of \$50.00 per hour up to \$200.00. If a start time is before 7:00am, an Early Opening fee of \$50.00 per hour will be assessed up to \$200.00. Call times for each must be given to your stagehand by 5:00pm the evening before.

## **CATERING**

Extra tables and chairs can be made available as an additional rental. Please reserve these items ahead of time. If you need suggestions for local places that cater, please refer to the "Around the Neighborhood" page.

## **TRASH DISPOSAL**

Each production is allotted two yards of trash for its stay. Additional trash can be disposed of for \$60.00/yard. If your production will need to dispose of a very large amount of garbage (large set pieces, etc.), please contact us so we can make proper arrangements for your shoot.

## **PARKING**

While Chemistry Creative doesn't have a private parking lot, our Brooklyn location makes street parking much easier than Manhattan, and most small and large productions have no problems with parking. We remind you to check proper street and alternate side parking rules.

New York City Department of Transportation offers a helpful online map that helps outline nearby street parking: [www.nycdot.info](http://www.nycdot.info). If you have more specific needs or need to get special permits, please contact The Mayor's Office of Film Theatre and Broadcasting: [www1.nyc.gov/site/mome/index.page](http://www1.nyc.gov/site/mome/index.page).

## **INSURANCE**

Insurance certificates and endorsements must be submitted at least three business days in advance of your shoot. Failure to submit your insurance will prevent your shoot from entering our studios. Our stage manager will provide you with insurance information.

# FLOOR PLANS

## CYC STAGE

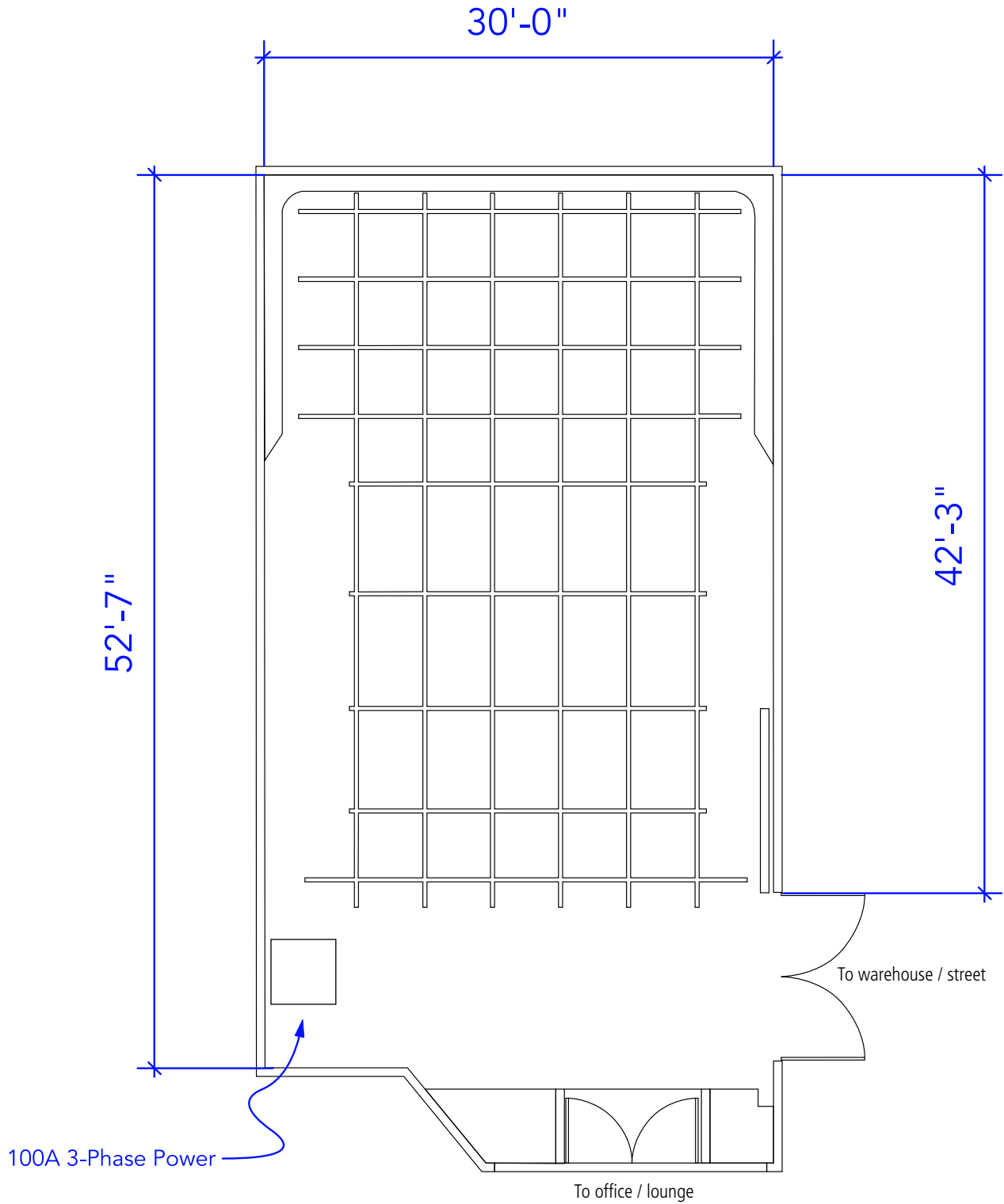

### HEIGHTS

Bottom of pipe: 13'7"  
Lowest ceiling point: 15'3 5/16"  
Highest ceiling point: 16'3 1/2"

# FLOOR PLANS

## RAW STAGE

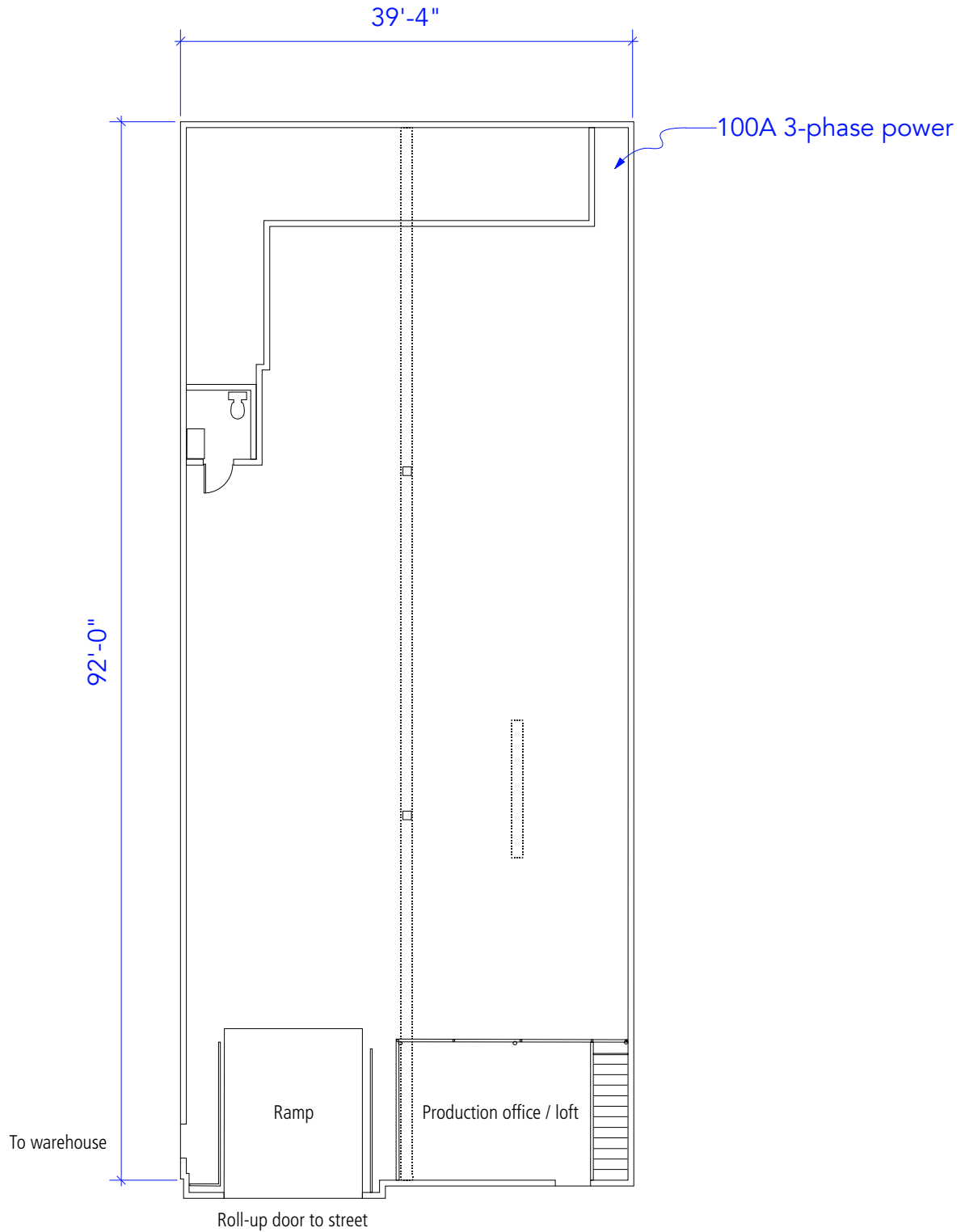

### HEIGHTS

Bottom of I-beams: 14'2 1/2"  
Lowest ceiling point: 15'3 1/2"  
Highest ceiling point: 16'3"

# RATES

---

## Photo / Film / Video Shoots

10 Hour Build	<b>\$1200</b>
12 Hour Build	<b>\$1400</b>
10 Hour Day	<b>\$1500</b>
12 Hour Day	<b>\$1750</b>
Overtime, per hour	<b>\$300</b>
Stage power (tie-in to camlok service), per day	<b>\$200</b>
Restore Cyclorama to White (305 only)	<b>\$200</b>
Small Tungsten Package, per day	<b>\$200</b>
Large Tungsten Package, per day	<b>\$400</b>
Small Kino Package, per day	<b>\$200</b>
Small LED Package, per day	<b>\$200</b>
Green Screen Setup, per day	<b>\$200</b>
Small Grip Package, per day	<b>\$150</b>
Large Grip Package, per day	<b>\$350</b>

---

Stage rental includes:

15 chairs, 2 director chairs, 3 tables, 2 clothing racks, steamer, cooler, 12' and 8' ladder

The additional stage can be rented for \$700/day for 10 hours, \$900/day for 12 hours

Additional support rooms (e.g. lounge, private hair /makeup room) are available for a fee.

For event rentals please call us for a custom quote.

50% rate is charged if cancellation is less than 48 hours notice.

100% rate is charged if cancellation is less than 24 hours notice.

\$150 cleanup charge if not moderately cleaned.

Crew and talent must be limited to 25 people or additional fees may apply.

Weekends and hours before 7am and past 8pm incur a site representative fee of \$50 per hour.

Camera gear, audio gear, extra grip, and lighting equipment packages are also available for rent.

We are not a sound stage and thus cannot guarantee complete audio isolation. However, commercials, web content, and even a feature film have successfully recorded sound in each stage.

# IN-HOUSE EQUIPMENT

Avail Qty

Item

## CAMERAS

- 1  Sony F5 4k with PL, Leica, Nikon and Canon EF mounts
- 1  Arri Amira
- 1  Arri Alexa XT
- 1  Red Epic Dragon w/ Canon EF and PL mounts
- 1  Red Weapon Helium 8K w/ Canon EF and PL mounts
- 1  Sony A6300 w/ Zoom Lens

## SUPPORT

- 1  Sachtler DV12SB Head
- 1  Dana Dolly Universal Kit
- 1  OConnor 1030HDS head w/ 25L carbon fiber sticks
- 2  Manfrotto video tripods with fluid heads
- 1  100mm bowl hi-hat

## CAMERA ACCESSORIES

- 1  Redrock Follow Focus
- 1  Movcam Follow Focus
- 1  Movcam MM-1 mattebox
- 3  V mount batteries
- 4  Anton Bauer Gold mount batteries
- 1  Teradek Bolt wireless video system

## DISPLAYS

- 1  SmallHD DP7 display
- 1  Panasonic LH1710 17" display with C-Stand mount
- 2  Eizo 27" displays
- 2  Panasonic 60" HDSDI displays w/ stands

## POWER

- 1  Motion Labs 100 a 3 phase power distro w/ 4 lunch boxes
- 1  Lex Pagoda Distro
- 1  900A Bates Distro
- 1  600A Bates distro
- 2  100A Lunchboxes
- 3  100A Bates 50' cable
- 1  100A Bates 25' cable
- 3  60A Bates 50' cable
- 2  100A to 2 60A splitter
- 1  60A to 3 20A Edison

## LIGHTING

- 1  Mole Richardson 10k Tener Fresnel
- 1  Mole Richardson 2k Fresnel
- 1  Mole Richardson 1k Fresnel
- 1  Mole Richardson 5k Fresnel
- 2  Mole Richardson 5k SkyPan
- 2  Mole Richardson 2k SoftLite
- 2  Mole Richardson 2k Focusing Scoop
- 1  Arri L7-C LED
- 1  Arri L5-C LED
- 2  Arri 750 Fresnel
- 8  Arri 650 Fresnel
- 1  Arri 150 Fresnel
- 1  Lite Panels Astra 1 x1 Bi Color LED

Avail Qty

Item

- 3  KinoFlo 4' 4 bank
- 2  KinoFlo Diva
- 2  KinoFlo Barfly
- 4  Desisti 2k zip lights
- 20  Leko lights w/ 19°, 26°, 50° lenses
- 4  Source4 pars
- 1  Chimera Triolet flood light
- 3  Lowell Tota light
- 4  Leprecon dmx dimmer packs
- 2  Magic Gadget 2k inline dimmer
- 4  1k inline dimmer
- 15  Chroma Q Color Force Compact LED lights w/ Chroma Q Brain
- 1  Smart Fade Console
- 1  Antari 350 Hazer
- 1  Chauvet Flex Fogger 1800
- 1  Martin Atomic 3000 Strobe
- 2  Medium Chimera
- 2  Small Chimera
- 1  20" Lantern

## LENSES

- 1  Angineux vintage 16mm
- 1  Leica Primes w/ EF Mount Cinemodded by Duclos  
(19mm/2.8, 28mm/2.8, 35mm/2.0, 50mm/1.4, 60mm/2.8, 90mm/2.0, 135mm/2.8)
- 1  Canon 70-200 2.8 L series
- 1  Canon 14mm 2.8
- 1  Voigtlander 50 1.4
- 1  Zeiss 25mm 2.0
- 1  Sigma 35 1.4

## COMPUTERS

- 1  DIT kit with iMac and accessories
- 1  MacBook Pro with Capture One 10

## AUDIO

- 1  Sound Devices 633 mixer/recorder
  - 2  Lectrosonics 411a receivers and 401a transmitters
  - 2  Sanken COS11D lavalier mics
  - 1  Sennheiser MKH50 hypercardioid mic
  - 1  Sanken CS3e shotgun mic
  - 1  Sanken CUB-01 boundary mic
  - 1  Zoom H6
  - 2  Comtek Transmitters
  - 3  Comtek Receivers
  - 2  Betso Sync Boxes
  - 1  Phonak IFB In Ear Receiver
  - 1  Neumann U87 and Awtac preamp for VO
  - 1  Sound Devices MM1 preamp
  - 1  Sound Devices USB Pre 2 preamp/audio interface
  - 1  JoeCo BBR-1 24 Track Recorder
  - 1  Apollo 16 audio interface
- Various mics, preamps, outboard gear and backline*

# IN-HOUSE EQUIPMENT

Avail Qty

Item

Avail Qty

Item

## GRIP

15	40" C Stand
2	20" C Stand
1	Matthews Super Crank Stand
4	Mole Richardson Junior Roller Stands
2	Junior Double Riser Roller Stands
2	Low Boy Combo Roller Stands
2	Double Riser Combo Stands w/ Lollipop Heads
2	Triple Riser Combo Stands w/ Lollipop Heads
3	Baby Roller Stands
2	Beefy Baby Stands
2	Preemie Stands
8	Full Apple Boxes
4	Half Apples Boxes
4	Quarter Apple Boxes
4	Pancakes
1	Camera cart
1	C stand cart
1	Rock n Roller cart
2	18" x 24" solids
2	18" x 24" frames
2	2x3 flag/solid
2	2x3 frames
1	2x3 silk
3	4x4 silk
4	4x4 frames
6	4x4 floppies
2	8x8 solids
2	8x8 frames
1	8x8 full grid
2	12x12 solids
1	12x12 frames
1	12x12 china silk
1	8x8 Bleached Muslin
8	Pigeon Plates
4	Duckbills
4	Big Ben Clamps
12	End Jaw Cardellini Clamps
8	Baby Studded C Clamps (6", 1 8")
6	Mega Clamps
10	50 lb bases with 10' steel pipe

*Various speedrail pieces (10', 8', 6', 4', 2')*

## MISC:

30	Folding Chairs
5	Director Chairs
4	6' Tables
6	8' Tables
2	Coolers
1	Scaffolding
2	12' Ladders
4	10' Ladders
8	Sound Blankets
30	Sandbags (more available if necessary)

***All expendables and cabling on site***



# EQUIPMENT PACKAGES

---

## GRIP

### Small Grip Package \$150

8 40" C stands  
2 20" C stands  
2 Low Boy Roller stands  
2 Double Riser Combo stands w/ lollipop head  
2 Baby Roller stands  
4 sound blankets  
10 sandbags  
2 duckbills  
1 apple box family  
10 safety cables  
1 baby triple header  
6 cardellini clamps end jaw  
2 mafer clamps  
2 junior to baby adapters  
2 big ben clamps  
6 6" baby studded c clamps  
10 spring clamps of each size (1, 2, 3)  
2 4x4 floppies  
1 4x4 set (solid, single, double, empty)  
1 2x3 set (solid, single, double, empty)  
1 18"x24" set (solid, single, double, empty)  
  
2 quad boxes  
4 cube taps  
8 50' edison  
8 25' edison

### Green Screen Setup \$200

12' chroma green seamless paper w/ stands

### Large Grip Package \$350

15 40" C stands  
2 20" C stands  
2 Triple Riser Combo stands w/ lollipop head  
2 Double Riser Combo stands w/ lollipop head  
2 Baby Roller stands  
1 Mombo stand  
2 Low Boy Roller stands  
2 Hi Boy Roller stands  
4 sound blankets  
30 sandbags  
20 safety cables  
1 baby triple header  
6 cardellini clamps end jaw  
4 duckbills  
2 mafer clamps  
2 junior to baby adapters  
4 big ben clamps  
6 6" baby studded c clamps  
20 spring clamps of each size (1, 2, 3)  
2 pieces of speed rail of each size (2', 4', 6', 8', 12')  
4 apple box families  
1 8x8 frame with corners and 2 ears  
1 12x12 frame with corners and 2 ears  
1 8x8 full grid  
1 8x8 bleached mus  
1 8x8 solid  
2 12x12 solid  
1 12x12 china silk  
4 4x4 floppies  
2 4x4 set (solid, single, double, empty)  
2 2x3 set (solid, single, double, empty)  
2 18"x 24" set (solid, single, double, empty)  
  
2 50' 100A bates  
1 25' 100A bates  
2 50' 60A bates  
1 25' 60A bates  
2 100A to 60A bates splitter  
10 50' edison  
10 25' edison  
4 quad boxes  
10 cube taps

## LIGHTING

### Basic Tungsten Package \$200

2 mole 2k soft lights  
1 mole 1k fresnel  
1 mole 2k fresnel  
3 arri 650 fresnel  
2 arri 750 open face w/ small chimeras  
1 arri 150 fresnel

### Large Tungsten Package \$400

1 10k mole fresnel  
1 5k mole fresnel  
2 5k mole skyfans  
1 mole 1k fresnel  
1 mole 2k fresnel w/ speedring and medium chimera  
2 s4 leko w/ lens  
3 arri 650 fresnel  
1 arri 150 fresnel

### Basic Kino Package \$200

2 4' 4 bank kino flow (w/ daylight and tungsten bulbs)  
2 2' kino flo diva lights (w/ daylight and tungsten bulbs)

### Small LED Package \$200

1 astra litepanel bicolor 1x1  
1 arri l7c bicolor fresnel  
1 arri l5c bicolor fresnel

*Ask for a full equipment list with more lights, camera, and audio.*

# AROUND THE NEIGHBORHOOD

---

## Restaurants

Aburi Sushi Bar  
769A Grand St  
(718) 387-8815

Arrogant Swine  
173 Morgan Ave  
(347) 328-5595

Bushwick Pita Palace  
243 Bushwick Ave  
(718) 456-9114

Brooklyn Standard  
766 Grand St  
(718) 218-8810

Champs Diner  
197 Meserole St  
(718) 599-2743

Pedro's Dumbo II  
812 Grand St  
(347) 294-4287

La Gringa Taqueria  
800 Grand St  
(718) 388-0055

Loving Hut Brooklyn  
76 Bushwick Ave  
(718) 388-7567

Newtown  
55 Waterbury St  
(347) 984-6215

Roberta's  
261 Moore St  
(718) 417-1118

Wafa's Express  
812 Grand Street  
(718) 576-3547

Bread Brothers Bagel Cafe  
810 Grand St  
(347) 599-2175

Sage  
299-301 Graham Ave  
(718) 2180-6644

## Coffee

City Of Saints Coffee Roasters  
299 Meserole St  
(929) 900-5282

Lula Bean  
766 Grand St  
(718) 218-8810

Dunkin' Donuts  
809 Grand St  
(718) 387-6033

## Bars

El Cortez  
17 Ingraham St  
(347) 599-2976

Anchored Inn  
57 Waterbury St  
(718) 576-3297

## Catering

The Director's Catering  
directorscatering.com  
(718) 386 7475

Something's Cooking  
somecook.com  
(718) 391-0002

Starstruck Catering  
starstruckcatering.net  
(917) 626-8960

## Grocery Stores

Bravo Supermarket  
785 Grand St  
(718) 387-2523

Khim's Millennium Market  
294 Graham Ave  
(718) 963-1110

C-Town Supermarket  
330 Graham Ave  
(718) 388-8968

## Delis

Gourmet Deli  
891 Grand St  
(718) 388-7614

T&A Deli  
90 Bushwick Ave  
(718) 782-3975

## Post Office

US Post Office  
263 S. 4th St  
(718) 387-2832

## Hospitals / Fire / Police

Woodhull Medical Center  
760 Broadway  
(718) 963-8000

CityMD Williamsburg  
154 N 7th St  
(718) 414-2013

Brooklyn Hospital Center  
240 Willoughby St  
(718) 250-6915

FDNY Engine 206  
1201 Grand St

90th Precinct  
211 Union Ave  
(718) 963-5311

## Drug Stores

Unity Drugs  
772 Grand St  
(718) 486-0344

Napolitano Pharmacy  
335 Graham Ave  
(718) 387-0124

Saldo Drugs  
384 Graham Ave  
(718) 389-8015

## Banks

Chase Bank  
819 Grand St  
(718) 782-6501

Bank of America  
47 Graham Ave  
(718) 599-3078

Capital One  
416 Metropolitan Ave  
(718) 210-5464

Citibank  
836 Manhattan Ave  
(347) 756-4626

## Gas Stations

BP  
1049 Grand St  
(718) 599-1546

Shell  
2 Bushwick Ave  
(718) 388-0310

## Hardware Stores

Crest True Value Hardware  
558 Metropolitan Ave  
(718) 388-9521

Oriental Lumber  
1154 Flushing Ave  
(718) 386-8200

Ace Hardware  
347 Knickerbocker  
(718) 497-5882

Home Depot  
585 Dekalb Ave  
(718) 230-0833

Decorama Building - Plumbing  
1233 Metropolitan Ave  
(718) 366-3083

RadioShack  
760 Manhattan Ave  
(718) 389-3788